



Home  
Concepts™

**WELLBORN**  
CABINET®

Whether you are a new family building an affordable first home or breaking ground on a weekend getaway spot, the Home Concepts brand by Wellborn Cabinet, Inc. was designed with you and your builder in mind. Home Concepts is part of the Wellborn family of products, ensuring quality at an economical price point.

Whatever you choose, Home Concepts is sure to have a style to fit your décor and budget. From our family to yours, we present the Home Concepts Series.



Kingston Square Maple, Light



Kingston Square Maple, Natural





Kingston Square Maple, Light



Kingston Square Oak, Medium

## Your Whole Home Solution

The Home Concepts Series provides a versatile selection fit for any room in your home. These examples show the Kingston Square door style in Oak, Medium used in both the bathroom and kitchen which gives the whole home a cohesive, traditional, and timeless look.

Think beyond the kitchen with Home Concepts which offers quality cabinetry for any space and style.



Kingston Square Oak, Medium



Hampton Square Maple, Natural



Hampton Square Maple, Medium

## A Timeless Treasure

The classic Hampton Square and Layton door styles are shown here in various finishes as an example of the quality craftsmanship you receive when choosing from Wellborn's Home Concepts Series. The maple cabinetry shown here looks great in various tones including natural, medium, and light and has the ability to adapt to ever-changing design trends and styles.

Real wood cabinetry in a classic profile never goes out of style and is sure to withstand the test of time.



Layton Maple, Light





York Maple, Sienna



Cambridge Square, Divinity

## Accessories



Single Oven Cabinet



Diagonal Corner Wall Cabinet



Shelves



Microwave Cabinet



Whatnot Shelf



Base Blind Corner Cabinet with Swing Out Shelves



Sliding Shelves



Base Lazy Susan



Double Wastebasket



Desk End Panel



Countertop Support

# Door Styles

## Hampton

- Traditional Overlay
- Veneer Recess Center Panel
- Profiled Door and Drawer Front Edges

### Hampton Square Maple



Natural Light Medium Sable Sienna Coffee

### Hampton Square Oak



Light Medium Sable Sienna Coffee

## Kingston

- Traditional Overlay
- Veneer Raised Center Panel
- Profiled Door and Drawer Front Edges

### Kingston Square Maple



Natural Light Medium Sable Sienna Coffee

### Kingston Square Oak



Light Medium Sable Sienna Coffee

## Layton

- Shaker Traditional Overlay
- Veneer Recessed Center Panel
- Square Door and Drawer Front Edges

### Layton Maple

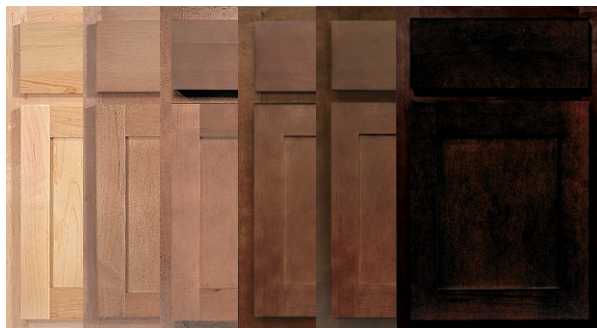

Natural Light Medium Sable Sienna Coffee

### Layton Oak

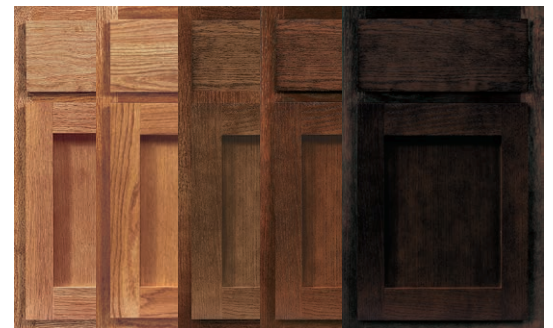

Light Medium Sable Sienna Coffee

## York

- Shaker Full Overlay
- Veneer Recessed Center Panel
- Square Door and Drawer Front Edges

### York Maple

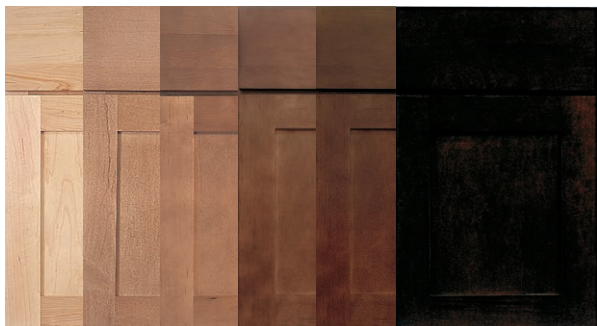

Natural Light Medium Sable Sienna Coffee

### York Oak



Light Medium Sable Sienna Coffee

## Cambridge Square WellCore MDF



### Cambridge

- Full Overlay
- Raised Center Panel Appearance
- Profiled Door and Drawer Front Edges

Glacier Divinity

Our line of Home Concepts quality cabinets offers both beauty and style at an affordable price. The product selections include beautiful door styles in Maple, Oak and MDF. Many doors have solid wood stiles and rails and a veneered center panel. This line of Wellborn cabinetry is sure to have a style to fit any budget and decor.

## Door Materials

### Maple



Maple is widely used in the cabinetry industry. This wood species features a straight grain with several distinctive characteristics. These include unique figures such as bird's-eye, fiddle back, mineral streaks and curly grain patterns. Finely textured with a natural luster, this creamy-white to light reddish-brown wood is often used for cabinets and floors.

### Oak



Authentic American red oaks are open-pored and have grain patterns. Wellborn's manufacturing technology presents Oak with straighter grains than most cabinet lines, and our process minimizes the wide grains and reduces the widths of cathedrals in Oak.

### WellCore MDF



Using high pressure and temperatures, MDF is formed by combining wood fibers with a wax resin binder to form panels. It is made of wood veneer. It is much more dense than normal particle board. This is a durable and tough wood product, commonly used in the construction industry.

# Cabinet Construction

## Standard

Backs: 1/8" wood grain laminated MDF with fiber board hanging rails.

Drawer Slides: 75-pound rated epoxy coated, double captive guide system, side mounted, adjustable, self-closing with mounting brackets at rear.

Adjustable Shelves: 3/4" furniture board with wood grain lamination on two sides, banding on edges and dual locking WellLock® Shelf Clips.

End Panels: 1/2" furniture board with wood grain laminated end panels and banded on top and bottom edges of wall cabinets to complement door.

Toe Kicks: 1/2" unfinished furniture board full height captive toe kick.

I-Beam: 1/2" x 3" I-Beam furniture board support dadoed into front, back and side.

Face Frames: 3/4" x 1 1/4" solid wood face frame, assembled using mortise and tenon construction.

Drawer Boxes: 3/4" furniture board drawer sides with wood grain lamination to match cabinet interior, tenoned to accept 1/2" sub-front and back. 1/8" Hardboard drawer bottom with wood grain lamination.

Drawer Fronts: Drawer front has adjustability.

Interior: Natural Maple wood grain laminate.

Cabinet Tops & Bottoms: 1/2" furniture board with wood grain lamination (solid wood brace on 36" wide and larger cabinets).

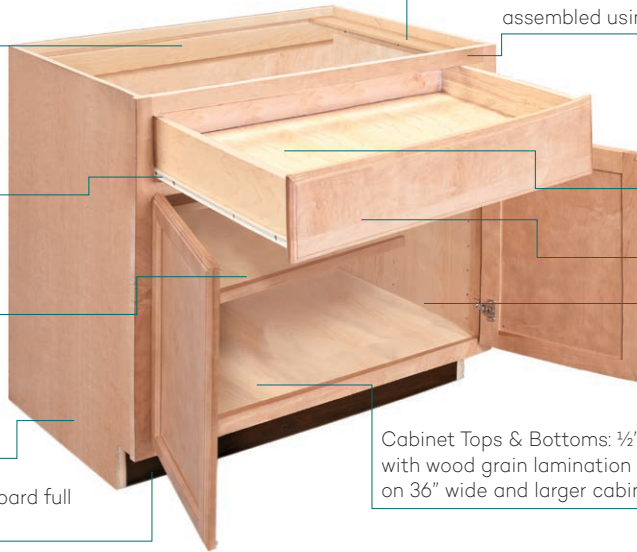

Cabinets 39" wide or wider will have center mullion.

## Standard Drawer



3/4" Laminated furniture board drawer sides with epoxy coated self-closing, side-mount drawer slides.

## Plywood Drawer Upgrade Option



3/8" Plywood drawer with dovetail joints and undermount full extension soft close drawer slides. Dovetail joints are unfinished.

## All Plywood Construction (APC) Option

Backs: 3/16" wood grain laminated plywood with solid hardwood or plywood hanging rails.

Drawer Boxes: 5/8" plywood dovetail drawer sides in a natural finish.

Drawer Slides: 75-pound rated epoxy coated, undermount soft close.

Adjustable Shelves: 3/4" plywood with wood grain lamination on two sides, banding on edges and dual locking WellLock® Shelf Clips.

End Panels: 1/2" unfinished plywood end panels. Matching Finished End Option available.

I-Beam: 1/2" x 3" I-Beam plywood support dadoed into front, back and side.

Face Frames: 3/4" thick, 1 1/4" frame, solid wood assembled using mortise and tenon construction.

Drawer Fronts: 3/4" solid wood drawer front.

Interior: plywood with Natural Maple wood grain laminate.

Toe Kicks: 1/2" unfinished plywood extends to cabinet floor for captive construction.

Cabinet Tops & Bottoms: 1/2" thick plywood with wood grain lamination (solid wood brace on 36" wide and larger cabinets).

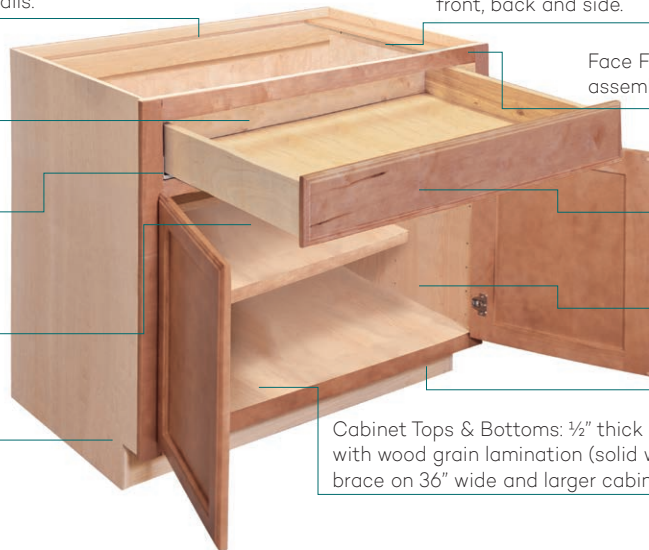

## Standard Drawer



3/8" Plywood drawer with dovetail joints and undermount full extension soft close drawer slides. Dovetail joints are unfinished.

Cabinets 39" wide or wider will have center mullion.

# Cabinets & Accessories

The Home Concepts product line includes all the cabinetry sizes you'll need to create the home of your dreams.

## Wall Cabinets

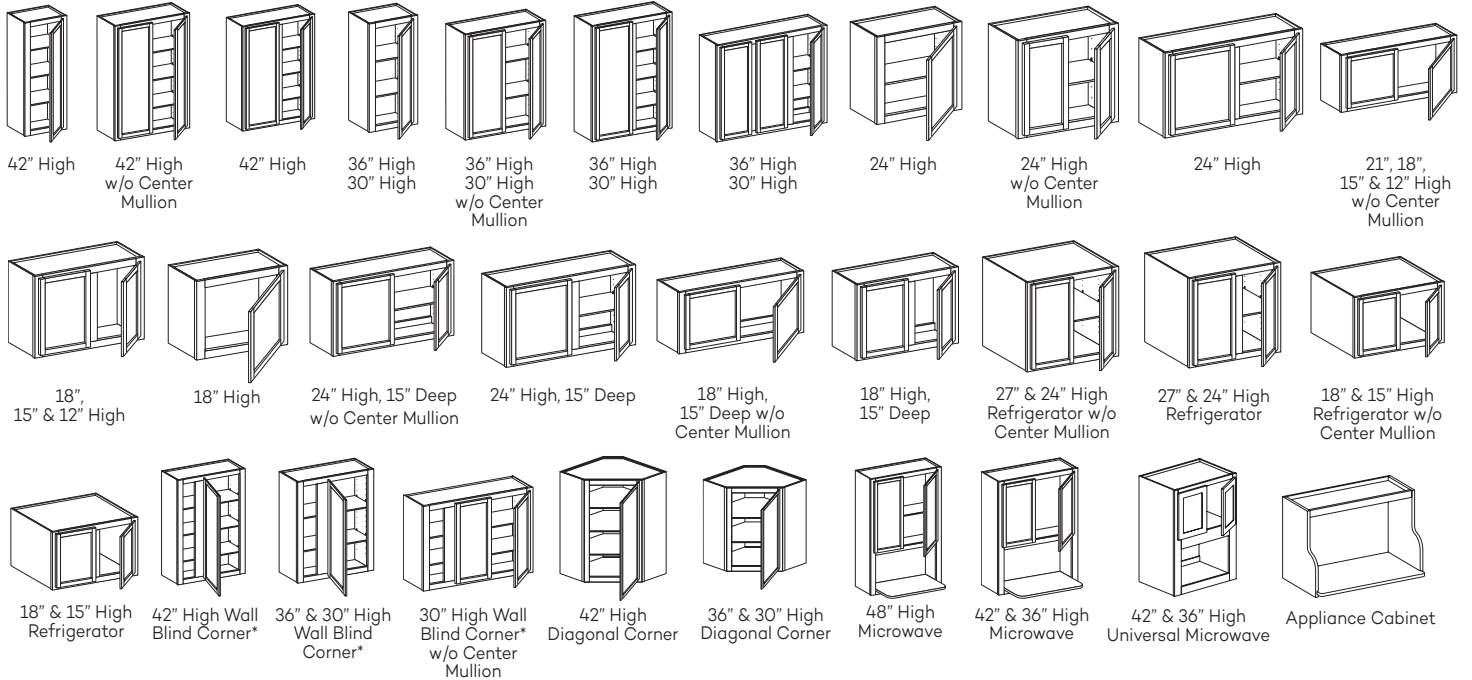

## Base Cabinets

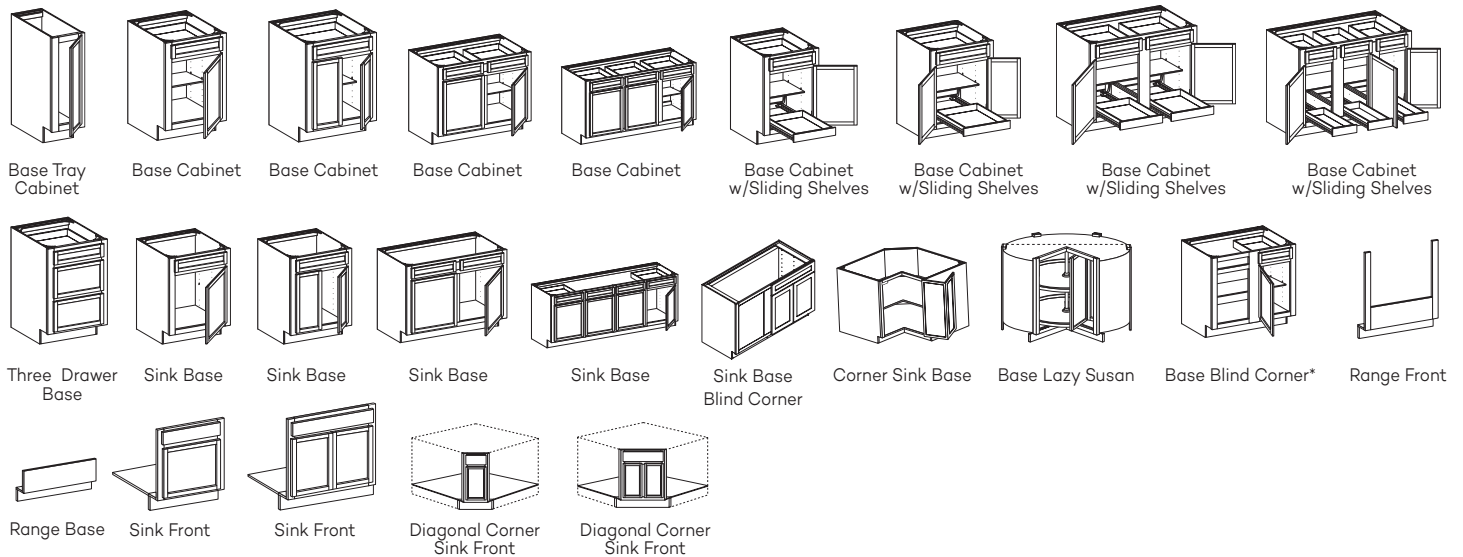

## Active Living Cabinets

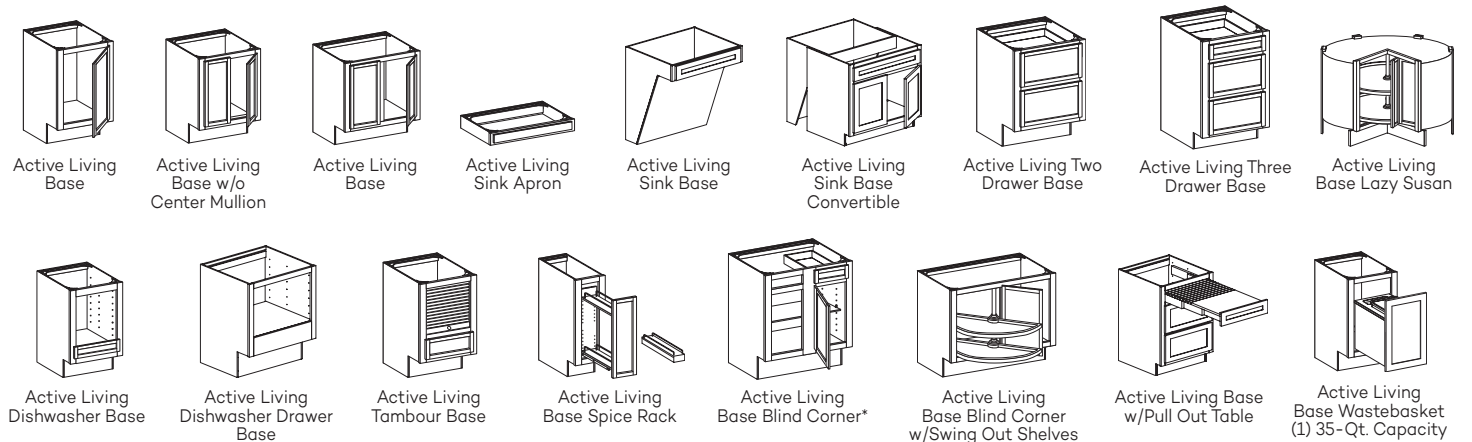

\*Left Blind Shown

## Active Living Cabinets (continued)

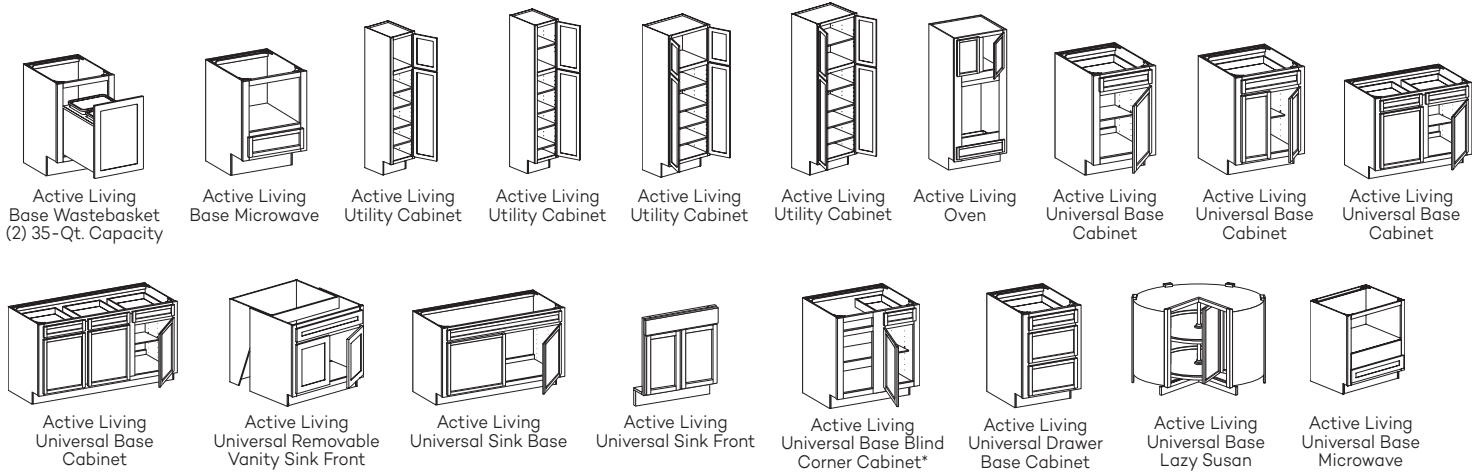

## Tall Cabinets

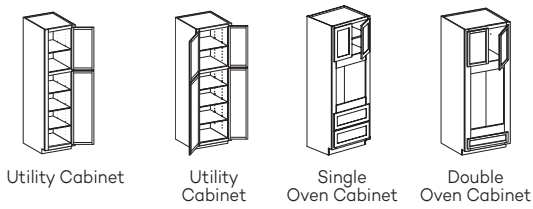

## Vanity Cabinets

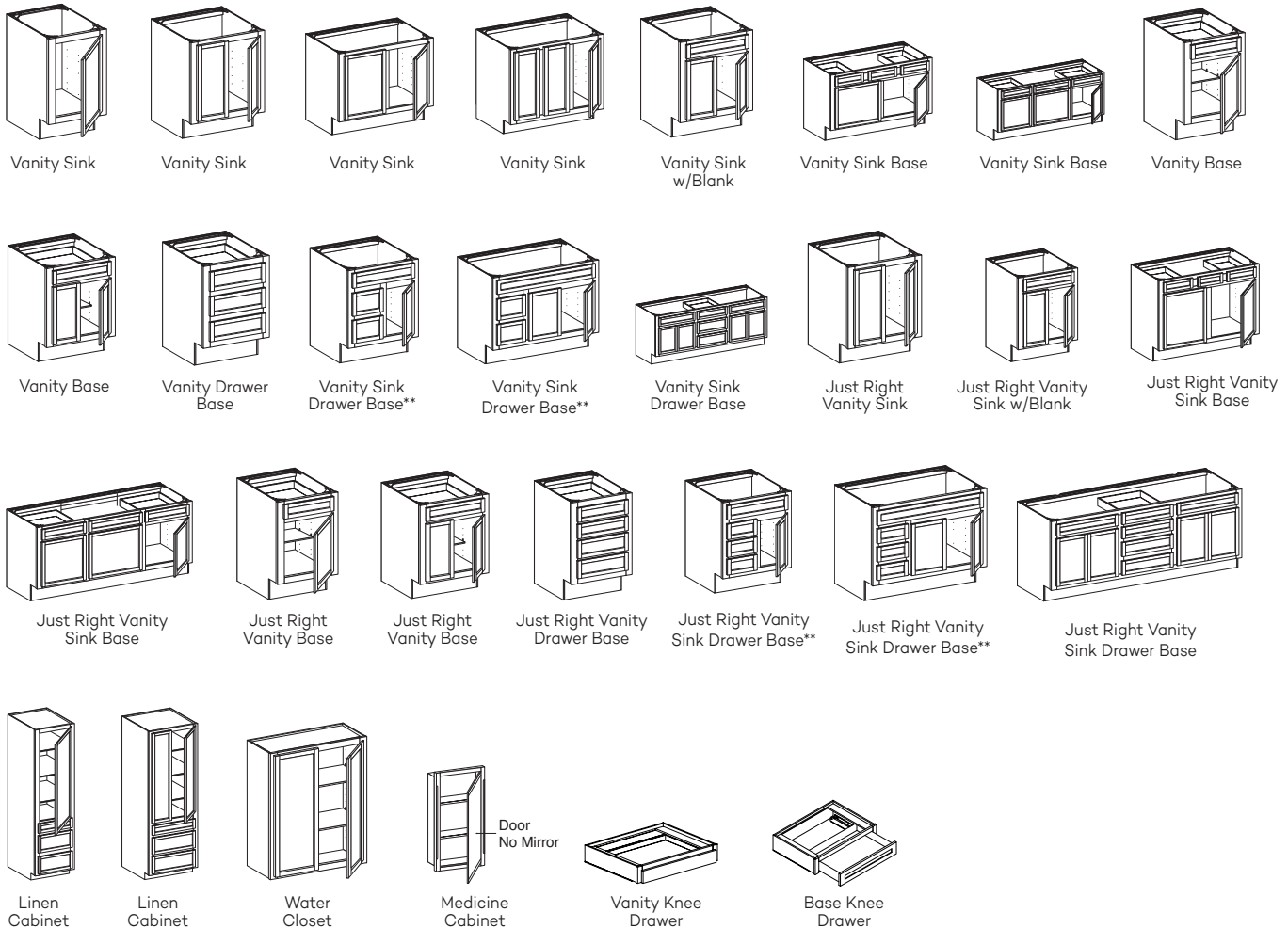

## Accessories

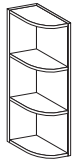

Whatnot Shelf



Diagonal Tambour Storage Unit

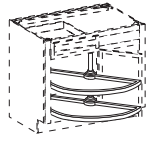

Swing Out Shelves

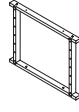

Center Mullion Kit

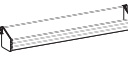
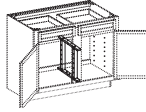

Tilt Out Tray



Sliding Shelves

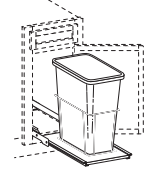

Single Wastebasket

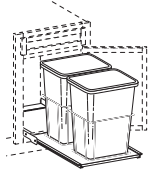

Double Wastebasket

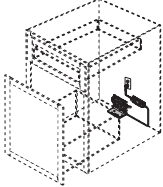

Wastebasket Touch to Open



Desk End Panel



18" Plastic Rotating Shelves

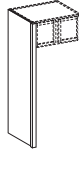

Refrigerator End Panel

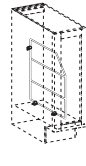

Wire Tray Divider

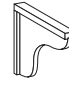

Countertop Support



Valance

## Mouldings



Batten Moulding



Shoe Moulding



Corner Moulding



Soffit Moulding



Inside Corner Moulding



Angled Inside Corner Moulding



Angled Outside Corner Moulding



Rope Moulding



Full Overlay Crown Moulding



Scribe Moulding



Shaker Crown Moulding



Small Crown Moulding



Crown Moulding



Traditional Crown Moulding



Decorative Crown Moulding



Classic Wood Edge Moulding



Light Rail Moulding



Decorative Panel Moulding

## Semi-Custom Options

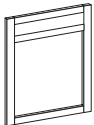

FFO - Face Frame Only



FH - Full Height Doors



FO - Front Only

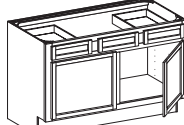

ID - Increased Depth

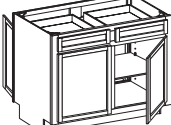

P - Peninsula

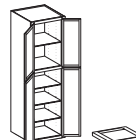

TKU - Toe Kick Unattached

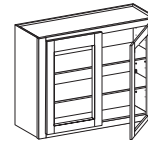

DDFIN - Decorative Door Frames Installed

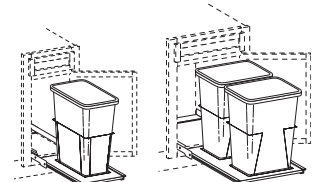

SWIN/DWIN - Wastebasket Kit Installed

## Function Ready Options

# OUR FACILITY

Since 1961, the Wellborn family has owned and operated Wellborn Cabinet, Inc. located in the southern part of the Appalachian Mountains in Ashland, Alabama.

# WELLBORN QUALITY

Since 1961, Wellborn Cabinet, Inc. has been manufacturing quality kitchen and bath cabinetry in Ashland, Alabama. It all began with a small cabinet shop building cabinets for local markets. After years of focus, determination and dedication to the craft, Wellborn has become a nationwide state-of-the-art manufacturing facility with over 1.8 million square feet of some of the most advanced technology systems in the industry and over 60 years of acquired knowledge in high quality cabinetry craftsmanship.



Environmental stewardship has been part of Wellborn's culture since its beginning. This responsibility has never been just about words. It has been about decades of actions, investments and practices. At Wellborn, we have recycling programs, utilize wood waste to generate power and steam and continue to lower VOC emissions through technology. We also partner with our suppliers to improve their environmental programs. This is why you will find the KCMA Environmental Stewardship Program seal on our cabinetry. The Green Choice program ensures that you are purchasing a brand of cabinets from a company that takes conscious steps to protect and minimize the overall impact on our environment.

Distributed by:



BY WELLBORN CABINET, INC.

38669 Highway 77 | Ashland, AL 36251  
(256) 354-7151 | Fax (256) 354-7022  
wellborn.com



 Cabinets that comply and bear the KCMA Certification Seal are recognized in the marketplace as a quality product able to perform after a rigorous battery of tests simulating years of typical household use.

Due to the natural variation and aging process, minor differences may be noticed in color match when replacing doors on existing cabinetry or adding additional cabinetry at a later date. It is a characteristic of stained wood finishes, laminate cabinetry to age over time when exposed to smoke, sunlight or general household detergents and chemicals. Therefore, we recommend using only a soft, clean cloth or furniture polish containing natural oils and cleaning emulsifiers to clean the finish of your Home Concepts wood cabinets. Products containing wax or silicone polishes are NOT recommended. In order to maintain the maximum quality and beauty of your laminate cabinetry, avoid exposure to moisture to the back edge of the doors. Undue wetness could result in delamination over time.

Due to the natural characteristics of wood and the limitations of photography and the lithographic printing process, the woods and wood finishes shown in this brochure may not accurately depict those offered by Home Concepts. See your local Home Concepts dealer for actual wood sample color selections and for complete warranty details. The Home Concepts Series has a machine sanded finishing process and does not include the detailed hand sanding technique featured in the Wellborn Collection. Wellborn Cabinet, Inc. does not warrant finish matching between the Home Concepts or Select Series and the Premier Series due to differences in wood characteristics and finishing processes. Any claim arising from or related to cabinet finish matching in such blended or mixed designs is specifically and expressly not covered under any warranty provision. Doors made with solid wood stiles and rails with plywood veneer center panels will vary in finish from the stiles and rails to the center panel due to the difference in materials. This is not considered a defect and is not covered under warranty.

